



FOR LEASE

Air Cargo Terminal 2, John Glenn Columbus International Airport
4750 E. Fifth Avenue, Columbus, OH 43219



Suite F 6,000 SF Available

Property Highlights

- 24,000 SF building
- Dock doors (10' x 10')
- Drive-in doors (14' x 10')
- Airside access to Port Columbus
- 22' clear height in warehouse
- 90' deep clear span warehouse
- Natural gas fired radiant heaters in warehouse

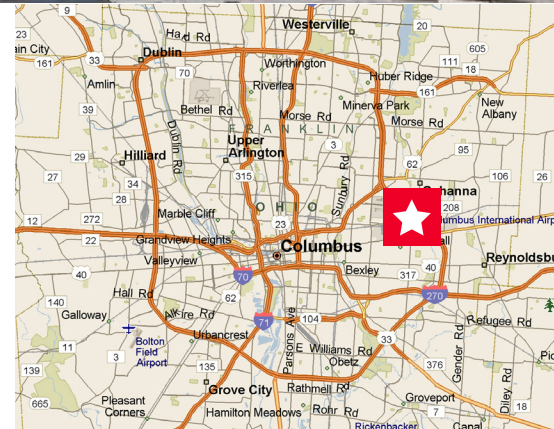

Mike Hurd
Senior Director
+1 614 827 1719
mike.hurd@cushwake.com

325 John H. McConnell Blvd., Suite 450
Columbus, Ohio
main +1 614 241 4700
fax +1 614 241 4701
cushmanwakefield.com



**CUSHMAN &
WAKEFIELD**

FOR LEASE

Air Cargo Terminal 2, John Glenn Columbus International Airport
4750 E. Fifth Avenue, Columbus, OH 43219

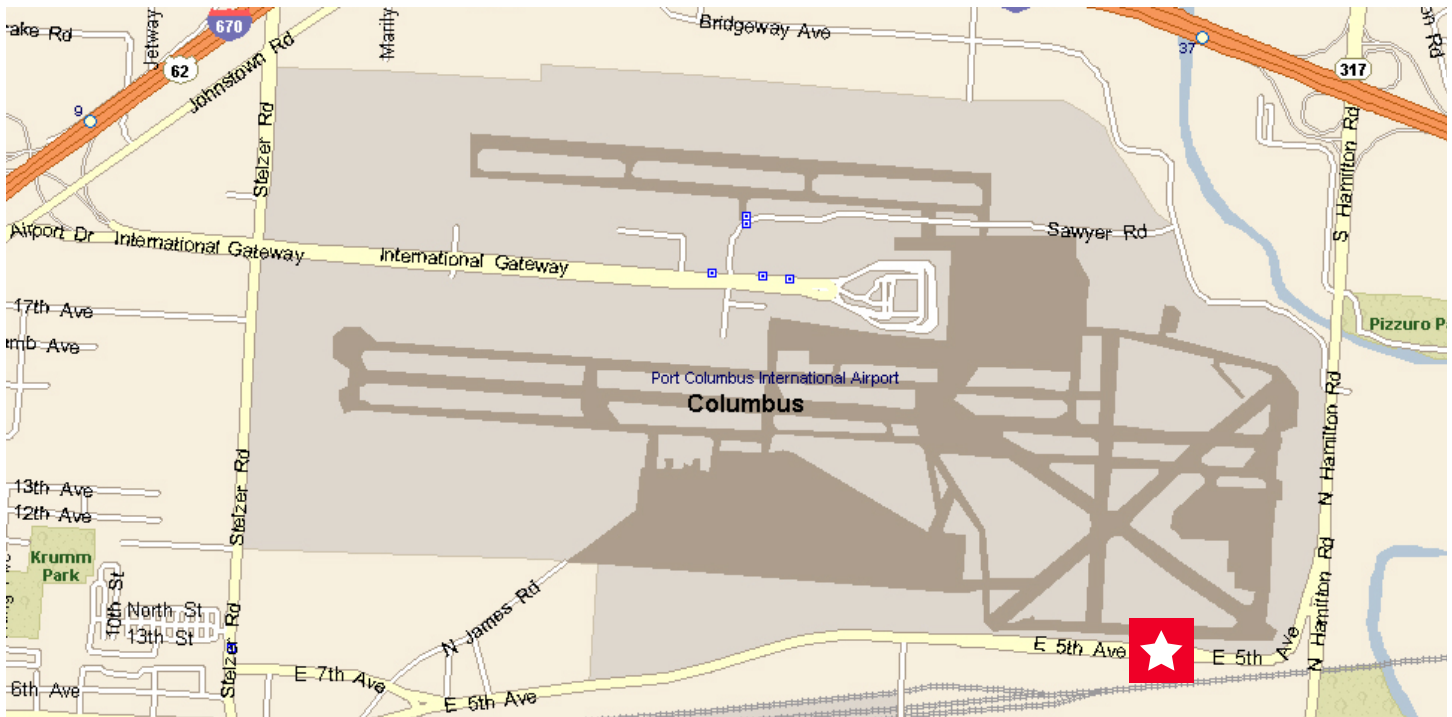
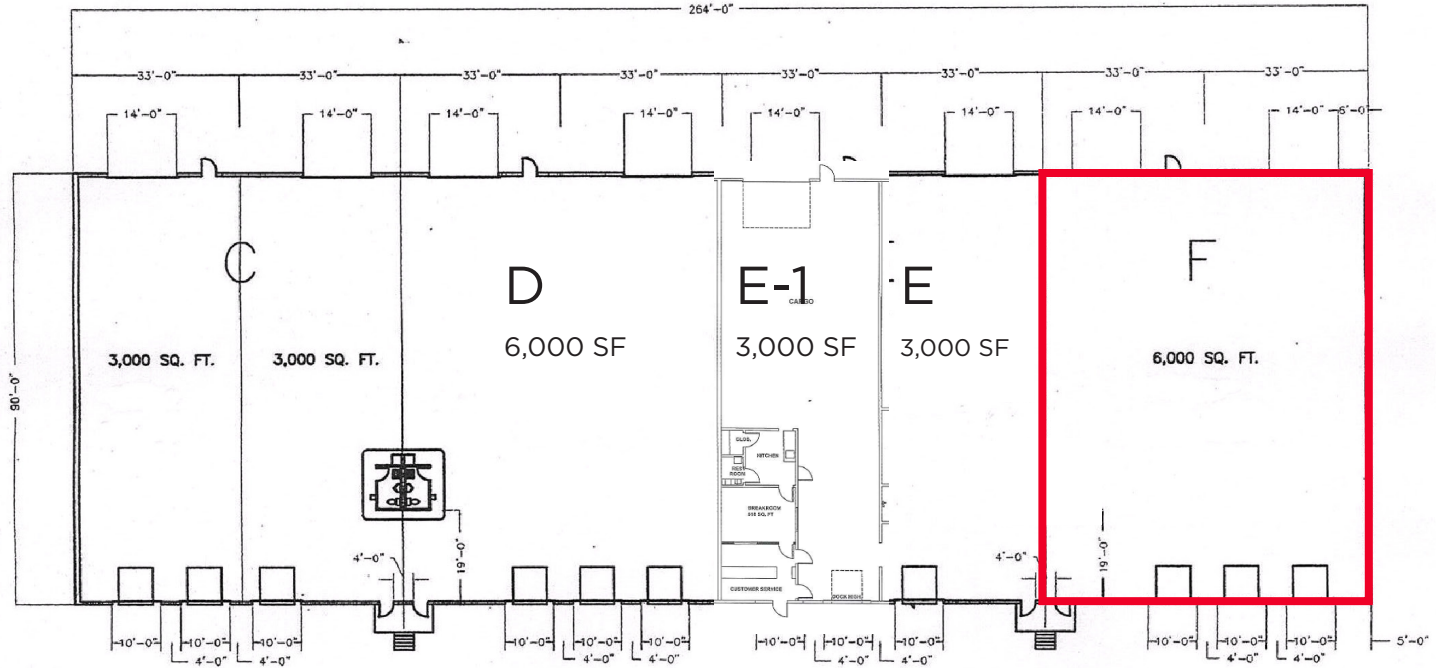

Mike Hurd
Senior Director
+1 614 827 1719
mike.hurd@cushwake.com

325 John H. McConnell Blvd., Suite 450
Columbus, Ohio
main +1 614 241 4700
fax +1 614 241 4701
cushmanwakefield.com